

User Manual

Mobi-Oil 2m/3m. Dia.160mm.

Oil-and Coolant mist.

Mobi-Oil is a Mobile Extractor-Filter for extraction and filtration of coolant mist and light oil mist from lathes, milling machines, drilling machines or other machines with the same problems.

Easy to use.

Move the Mobi-Oil to the machine. Plug it into an electric socket and start to use it. The super flexible Extraction-Arm 2m or 3m (Order separately) makes it very simple to put the hood into the right position. Adjust the damper in the hood so just the mist is exhausted. No bad air or slippery floors any longer.

Liquid Containers.

The filtered liquid is collected at the bottom of the Mobi-Oil in 2 plastic containers. You can see from the outside when a container is full. Then just move the hose, which is equipped with a quick connector, to the empty one. No down time! Then empty the full container and put it back. The liquid can normally be reused in the machine.



Five Step Filtration - 99.95% Efficiency.

1) Inlet "Splash Plate". 2) Expansion Chamber. 3) Labyrinth Filter. 4) Long Life nailed Glass-fiber Cassette with Alu Separators. 5) HEPA H13 FILTER. (1-3 can be cleaned).

	Art. No.
Mobi-Oil. 1-phase/0.75kW/220V/50Hz. Start/stop. 4m Cable with Plug. All Filters included. 4 Heavy Duty Castors with Brakes. 550mm(W)x780mm(D)x1430mm(H).	P-603
Mobi-Oil. 3-phase/0.75kW/440V/50Hz. Start/stop (no Cable). All filters included. 4 Heavy Duty Castors with Brakes. 550mm(W)x780mm(D)x1430mm(H).	P-604
Flexi Oil Mist Extraction Arm 2m. Diameter 160mm with turning flange and damper.	P-606
Flexi Oil Mist Extraction Arm 3m. Diameter 160mm with turning flange and damper.	P-607
Replacement HEPA Filter H13 9m².	P-596
Replacement Cassette Filter. Nailed Glass-fiber with Aluminum Separators (4.5+4.5m ²).	P-600

Table of Contents

1.0 General Information

- 1.1 Safety Note**
- 1.2 Range of Application**
- 1.3 Unit Description**
- 1.4 Installation**
- 1.5 Electrical**
- 1.6 Start-Up**
- 1.7 Technical Data**
- 1.8 Fan Data**

2.0 Maintenance

- 2.1 General Information**
- 2.2 Filter Changes**
- 2.3 Replacement Filters**
- 2.4 Spare Parts**

3.0 Extraction Arms

- 3.1 General Information**
- 3.2 Spare Parts**

1.0 General Information

Mobi-Oil is a mechanical emulsion mist and light oil mist separator with a degree of separation of 99,99% for particles bigger than 0.3 microns.

The device is equipped with a labyrinth filter, a fiberglass flies filter cassette with aluminium separators and HEPA-Filter.

The complete unit consists of::

- ✓ Housings made from powder coated steel sheet
- ✓ Labyrinth filter
- ✓ Filter cassette
- ✓ Fan
- ✓ HEPA filter
- ✓ 2 Pressure gauges
- ✓ Switch with overload protection
- ✓ Electric Cable with Plug (Not 3-Phase Model)
- ✓ 2 containers for separated liquid with 1xQuick Connection Hose
- ✓ 4x Pivoting Wheels with Brakes
- ✓

1.1 Safety Note

Always disconnect the supply voltage before opening or servicing the device.

Don't exhaust sparks or other objects which can cause fire.

Keep the hood away from moving parts on the machine from which you exhaust mist.



1.2 Range of application

Separation of emulsion mist and light oil mist from Lathes, Milling Machines, Drilling Machines and other works with the same problems.

1.3 Unit Description

HEPA-Filter: Meets all environmental certification requirements. Degree of separation 99.99%. Not possible to wash but easy to replace.

Fan, Circuit Braker and 2xPressure Gaughes

Glasfiber Filter Cassette with Alu. separators. Door

Labyrinth-Filter

2 x Liquid Containers and 1xHose with Quick Connector

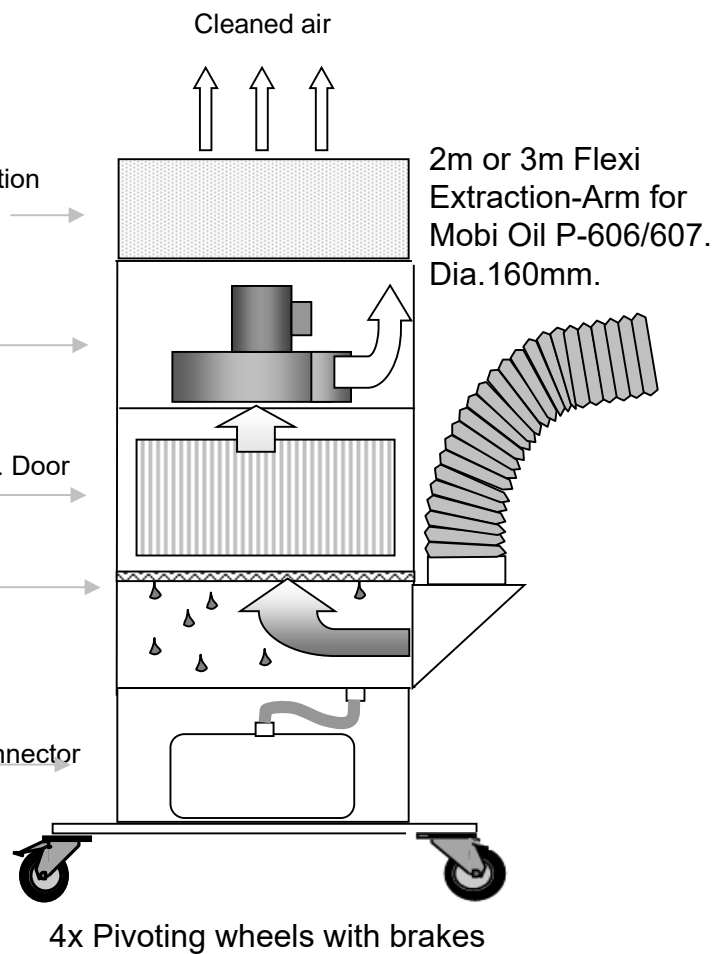

1.4 Installation

Mobil Oil is suitable for indoor use in dry areas. Mount the Extraction-Arm on the intake on the Mobi-Oil. Bring the unit to the machine. Connect the electric plug to the wall. Switch the unit on. Place the hood so close the spot where coolant mist or light oil mist is generated that just the mist is exhausted. Not Liquid! The Cleaned air is blown out upwards. When the Glasfiber Filter is saturated clean oil will start to drop down into the connected container. Through the inspection hole on the lower part of the Mobi-Oil you can see when the container is full. You then open the door and switch the oil hose to the empty container and remove the full. No disturbance of the work.

1.5 Electrical

Mobi-Oil 1 Phase comes complete with switch with overload protection, 4m cable and plug .

Mobi-Oil 3-Phase comes with switch with overload protection, but without cable and plug..

The electrical installation of the 3-phase unit is only to be done by a qualified and licensed electrician.

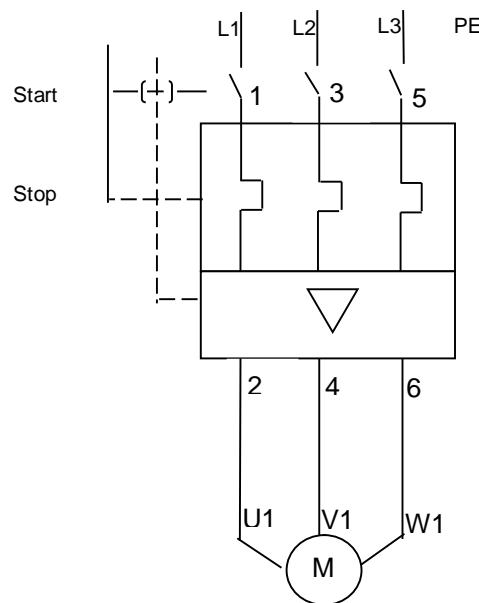

1.6 Start-Up

Before start-up, please read the owners manual and be familiar with the operation of the unit.

Determine that the filter cartridges are correctly mounted in the unit.
(gasket upwards and exenter buckles upwards)

Mobi-oil 3- fase. Observe the direction of rotation when switching on the fan. During correct rotation the pressure gauge at the HEPA-Filter shall indicate a pressure drop of ca.140 Pa (with 3m Arm). With shorter arm the pressure drop will be higher.

1.7 Technical Data

Dimension:	Length:	610mm
	Width:	550mm
	Height:	1.480mm (with HEPA-Filter)
Filter surface:	Fiber Filter:	4,5 + 4,5m ²
	HEPA H13 Filter:	9m ²

AIR INTAKE FOR DIAMETER 160MM OR 200MM INLET FLANGE Or FOR DIA.160mm/2M OR 3M EXTRACTION-ARM.

1.8 Fan Data

Operating Voltage	230V/ 1~	400V/ 3~
Capacity	0,75kW	0,75kW
Amp	5 A	1,83A
RPM	2.900 U/min	2.900 U/min
Frequency	50 Hz	50 Hz
Safety class	IP 54	IP 54

2.0 Maintenance

2.1 General Information

The filter cassette is self cleaning and service life is normally around 2 years or more.

The HEPA-Filter should be changed after around 18 months

2.2 Filter Changes

Turn unit off and loosen the quick-locking of the door. Remove the door from the device.

To remove the filter cassette, turn the exenter buckles down horizontally.

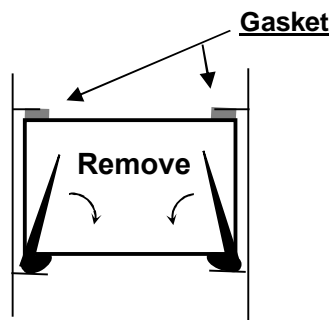

Install the new Filter Cassette with the Gasket Upwards. Turn the exenter buckles upwards.

The HEPA filter is changed by unlocking the exenter locks.

2.3 Replacement Filters

HEPA-Filter Art.Nr. P-596
Filter cassette Art.Nr. P-600

2.4 Mobi-Oil Spare Parts.

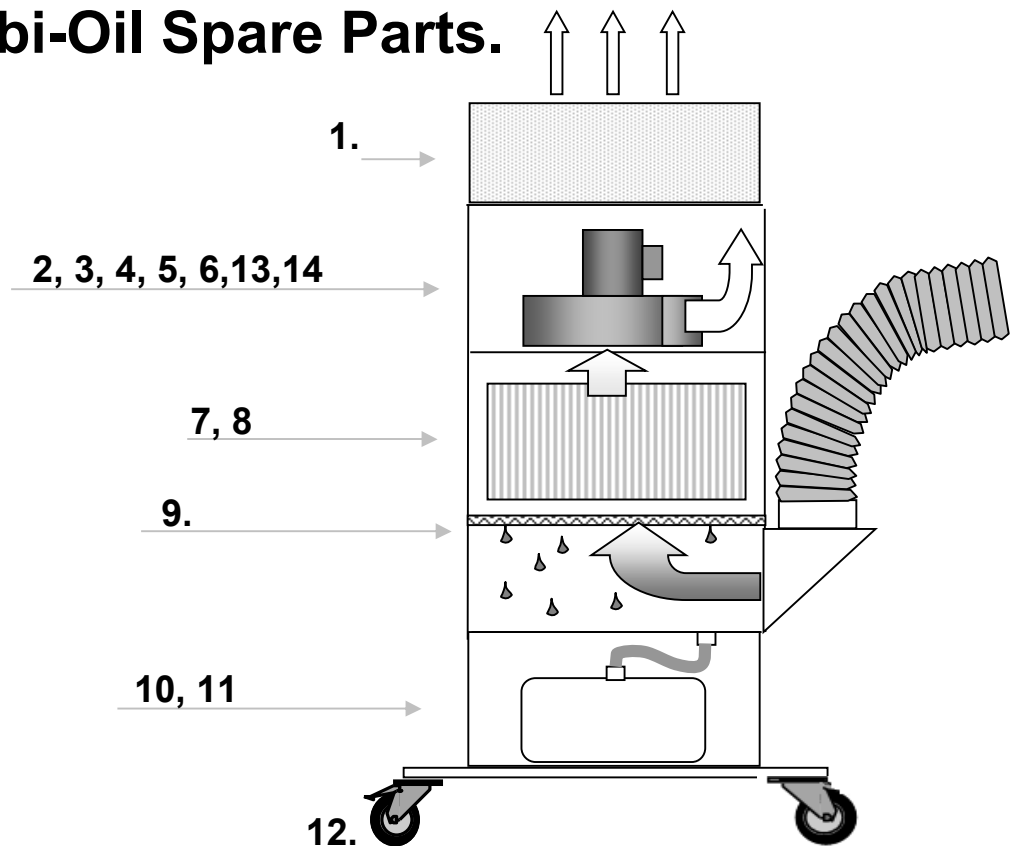

When ordering Spare Parts please specify Name of Product, No. and specification of Spare Part from below and the quantity of each part.

1. HEPA H13 Filter Box 9m². P-596.
2. Electrical Switch with Overload Protection for 1-Phase.
3. Electrical Switch with Overload Protection for 3-Phase.
4. Electric Motor 1-Phase/0.75 kW/2900r/50Hz.
5. Electric Motor 3-Phase/0.75kW/2900r/50-60Hz.
6. Impeller.
7. Door complete.
8. Cassette Filter 4.5m²+4.5m². P-600.
9. Labyrinth Filter.
10. Liquid Container (1pc.).
11. Oil Hose with Quick Conector complete.
12. Pivoting Wheel with Brake (1pc.)
13. Pressure Gaugh (1pc.)
14. Cable and Plug for 1-Phase.

3.0 Flexi Extraction-Arms for Mobi-Oil. P-606 and P-607.

3.1 General Information.

The Flexi Extraction-Arms for mounting on Mobi-Oil, are designed to extract coolant mist and light oil mist. They have a swivel which allows the Arm to be rotated 360 degrees. The flame-proof flexible hose, with covered steel spiral, has a parallelogram system inside to balance the hose and hood. This makes the Hood extremely easy to move to a new position and will stay there.

The Flexi steel hood is black painted and can be turned 90 degrees in all directions and has a built in Damper. It can easily be positioned at any point within the working area.

The Flexi Extraction-Arms 2m and 3m with dia.160mm for Mobi-Oil can be mounted directly to the inlet of the unit.

Max temperature of the exhausted air is 70 Degrees Celsius.

3.2 Spare Parts: Flexi Extraction-Arm, 2m/3m/160mm, for Mobi-Oil.

SPARE PARTS	ERSATZTEILE	PIÈCES DE RECHANGE	PIEZAS DE REPUESTO
-------------	-------------	--------------------	--------------------

P-606 and P-607

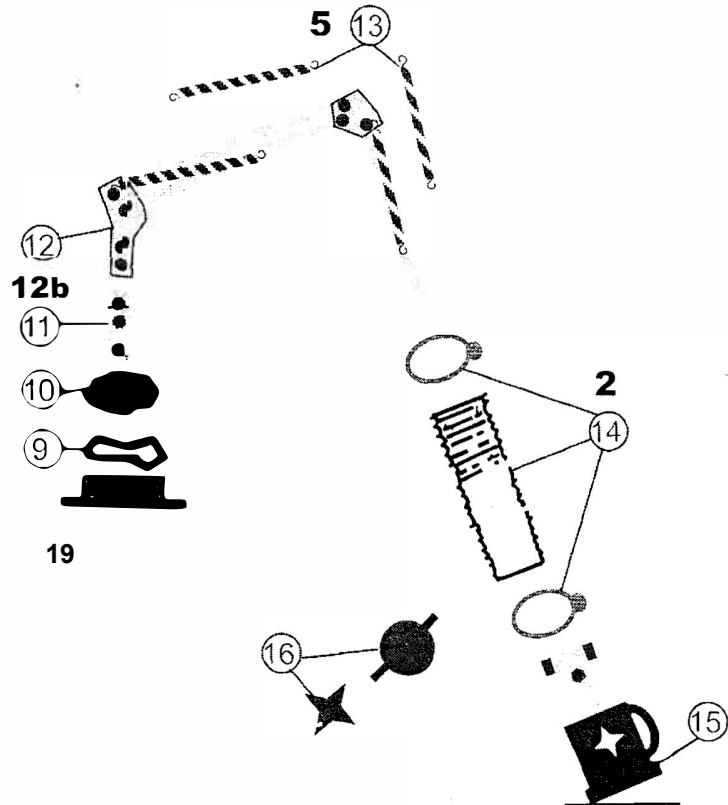

ENGLISH ORDER INSTRUCTION

When ordering spare parts always state:
-Name of the Product.

- Detail no. of the spare part and the name (as per list below).
- Quantity of the parts required

DEUTCH BESTELLANLEITUNG

Bei der Bestellung von Ersatzteilen immer angeben:
- Ersatzteilnummer und Beschreibung (s. Liste unten).
- Anzahl erforderlicher Ersatzteile.

FRANCAIS INSTRUCTIONS DE COMMANDE

Lors de la commande de pièces de rechange, toujours spécifier:
- Numéro de détail et dénomination (voir liste).
- Quantités des pièces requises.

ESPAÑOL INSTRUCCIONES DE PEDIDO

Quando pida repuestos especifique siempre:
- N° de pieza del repuesto (en la lista).
- Cantidad de repuestos requeridos.

<p>1.</p> <p>2. Hose+Hose Clamps 2m Arm</p> <p>5. Spring Set 2m Arm</p> <p>9. Rubber kollar</p> <p>10. Hose ring of Plastic</p> <p>11. Shaft</p> <p>12. Inside Arm 2m complete</p> <p>12b Inside Arm 3m complete</p> <p>13. Spring set 3m Arm</p> <p>14. Hose+Clamps 3m Arm</p> <p>15. Hood, complete</p> <p>16. Damper set</p> <p>19 Arm Holder</p>			
---	--	--	--



Declaration of conformity

We, J. Plymoth AB, declare under our sole responsibility that the product lines **Flexa, Chemikus, Flexi, Super-Max and Super-Vac Extraction-Arms** to which this declaration relates is in conformity with Directives 2006/42/EC and Standards EN ISO 12100:2010 and EN ISO20607;2019.

J. Plymoth AB
Traryds Allen 4D
28772 Traryd

Jenny Nilsson
Verkställande Direktör

2023-01-01



Declaration of conformity

We, J. Plymoth AB, declare under our sole responsibility that the product lines **WF-Eco, MF-F9/HEPA, MF-Active Carbon, MF-HEPA/W3 18M2, MF-Eco/F9, MF-Eco/HEPA, MF-Filter-Tables, MF-Eco Filter-Tables, FK-Mesa Backdraft Filter-Tables, MKF Filter-Tables, Labbe, MF-Lab, MF-Eco Lab, CF Central Filters, Mobo-Oil, Denta-Flex, Fica-Flex and VBF-Office** to which this declaration relates are in conformity with Directives 2006/42/EC, 2014/30/EU, 2011/65/EU and Standards EN 60204-1:2006, EN ISO 12100:2010, EN ISO 15012-1:2013, EN 61000-6-2005, EN 61000-6-3:2007, EN ISO 20607:2019.

J. Plymoth AB
Traryds Allen 4D
28772 Traryd

Jenny Nilsson
Verkställande Direktör

2023-01-01