

ORIGINAL[®]
Plymoth

User Manual

Flexi 1.5m, 2m, 3m, 4m, 5m.

Dia. 160mm/200mm.



Note! Before installation and use, please read instructions below.

List of Contents

- 1. User regulations**
- 2. Safety**
- 3. User instructions**
- 4. Installation Instructions**
- 5. Spare parts**
- 6. Maintenance**
- 7. Declaration of Conformity**

1. User Regulations

The **Flexi** Extraction-Arms are designed to extract fumes, gases and dust. The included Wallbracket has a swivel which allows the Arm to be rotated 360 degrees. The flame-proof flexible hose, with covered steel spiral, has a parallelogram system inside to balance the hose and hood. The steel hood is black painted and can be turned 90 degrees in all directions. Built in damper. The extraction arm can be equipped with a separate fan or be connected to a central fan system. Max Vacuum is 1500Pa.

Max temperature of exhausted air is 70 degrees Celsius.

2. Safety.

The product is designed to meet the requirements of the relevant EC directives. To maintain this status all installations, repair and maintenance work must be carried out by qualified personnel using only original spare parts. Contact your nearest authorised dealer for advise

WARNING ! Ignition risk for some dust or solvents!

**Check that no Objects which can cause fire are sucked into the arm.
Avoid impacts against hood.**

3. User Instruction.

Flexi Extraction-Arms are designed for capturing dust, fumes and gases and the Hood can easily be positioned at any point within the working area.

For the best capturing efficiency, the hood should be positioned as near the fume or dust generating process as possible but without sucking in sparks.

Always dimension your systems so the airflow is sufficient for the application in question.

Recommended airflow for Flexi Extraction-Arms is 700-1000m³/h for dia. 160mm and 1000-2000m³/h for dia. 200mm.

4. Installation

Instruction.

**Flexi Extraction-Arms 1.5-3m.
D.160mm/200mm.**

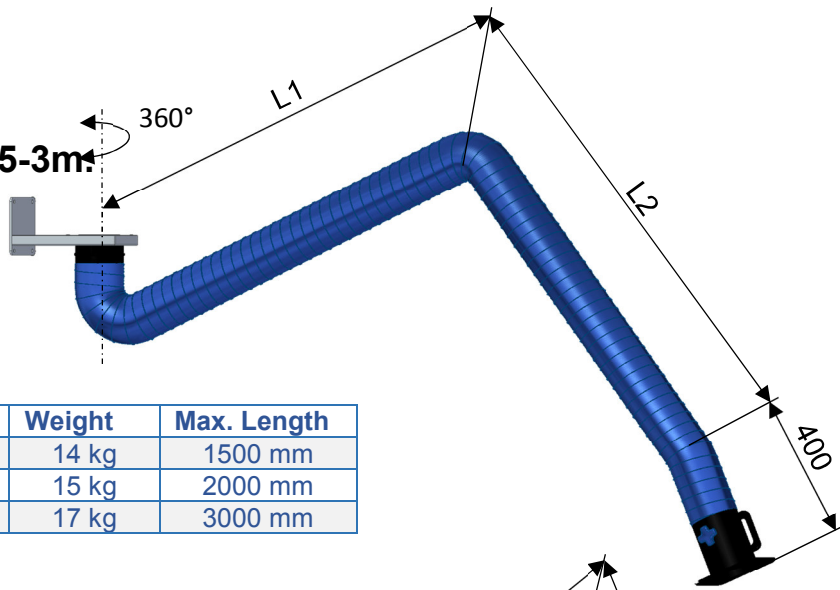

Arm	L1	L2	Weight	Max. Length
1,5 m	500 mm	400 mm	14 kg	1500 mm
2,0 m	800 mm	600 mm	15 kg	2000 mm
3,0 m	1400 mm	1200 mm	17 kg	3000 mm

**Flexi Extraction-Arms 4m-5m.
D.160mm/200mm.**

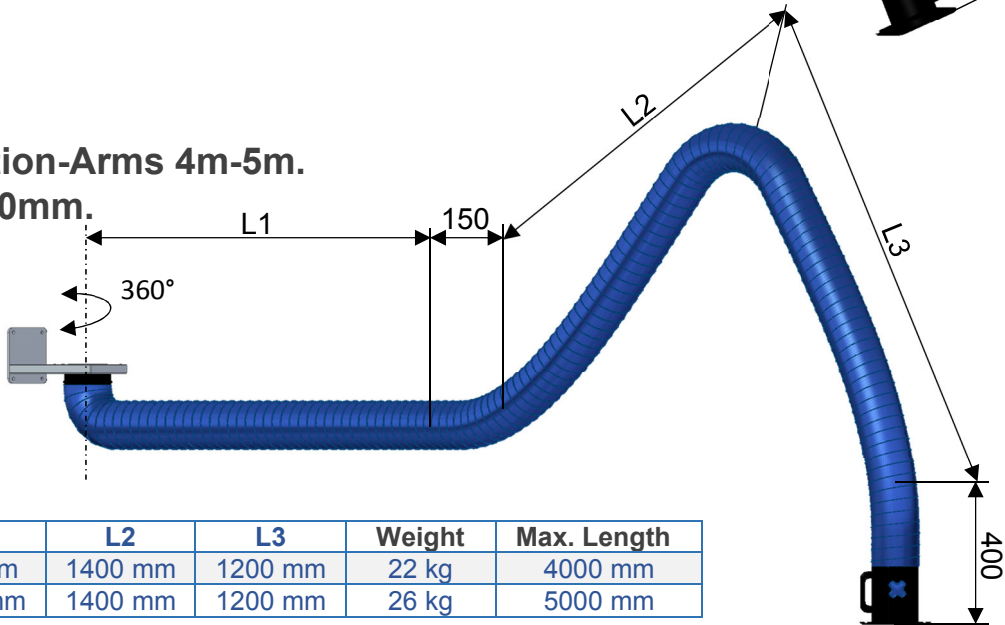

Arm	L1	L2	L3	Weight	Max. Length
4,0 m	600 mm	1400 mm	1200 mm	22 kg	4000 mm
5,0 m	1700 mm	1400 mm	1200 mm	26 kg	5000 mm

Wallbracket for D.160mm and D.200mm Flexi Arms.

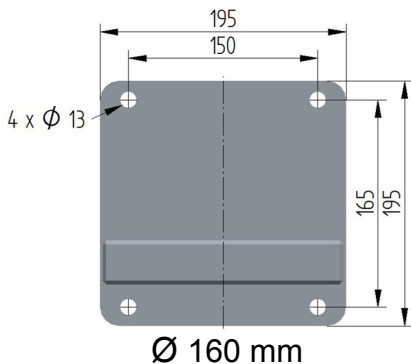

**Each of the wall bolts
must stand a traction
power of min 1600N.**

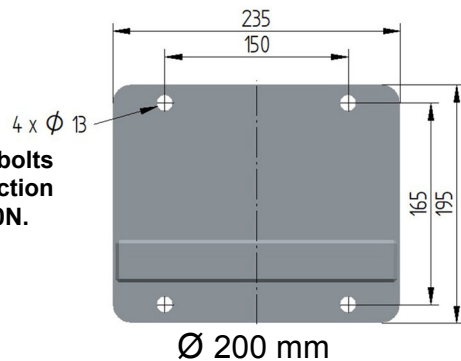

Flexi 1.5m, 2m, 3m, 4m, 5m. $\varnothing 160\text{mm}$ and $\varnothing 200\text{mm}$.

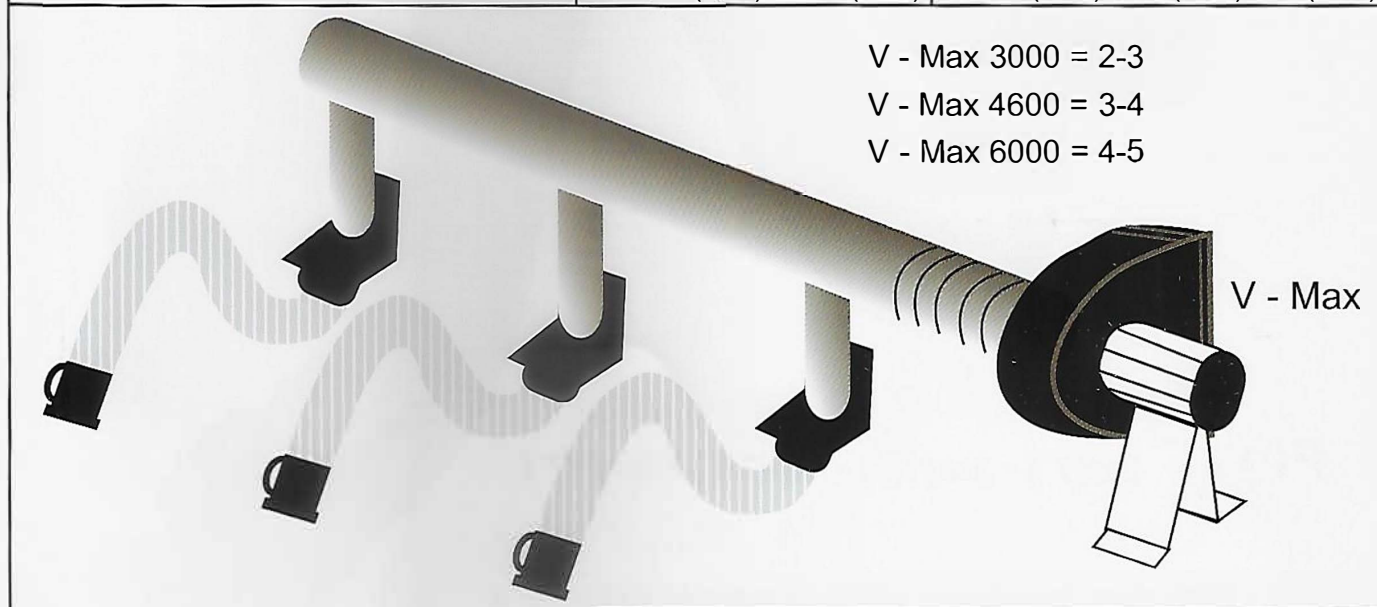
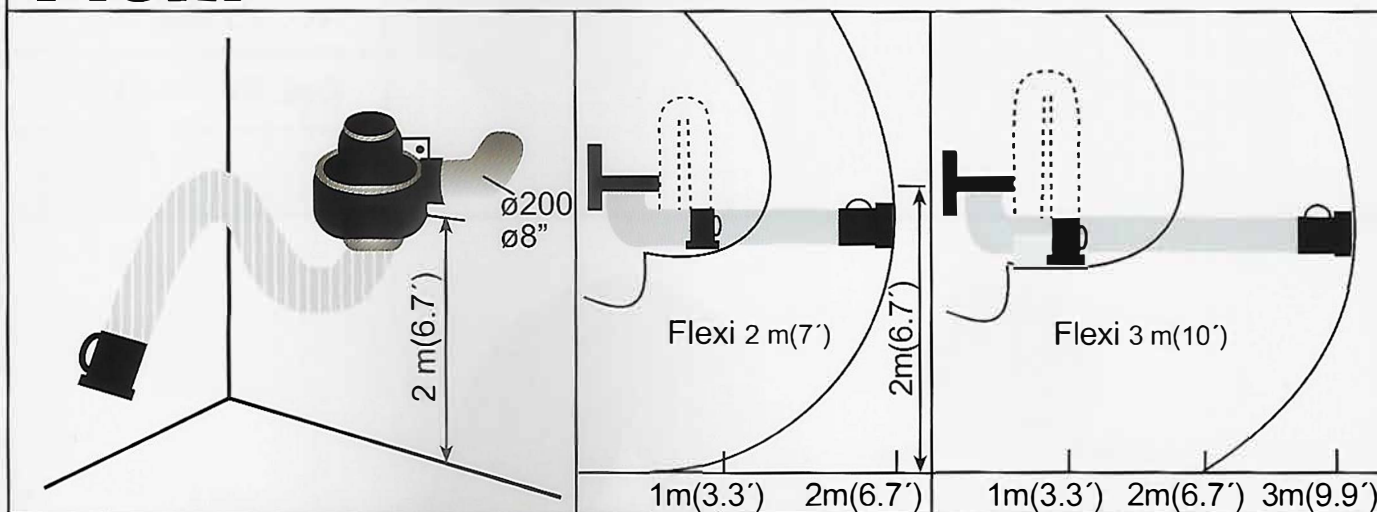

V - Max 3000 = 2-3

V - Max 4600 = 3-4

V - Max 6000 = 4-5

V - Max

Flexi[©] 4m(14')•5m(17')

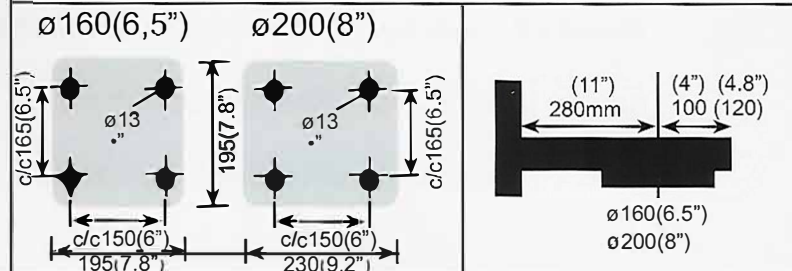
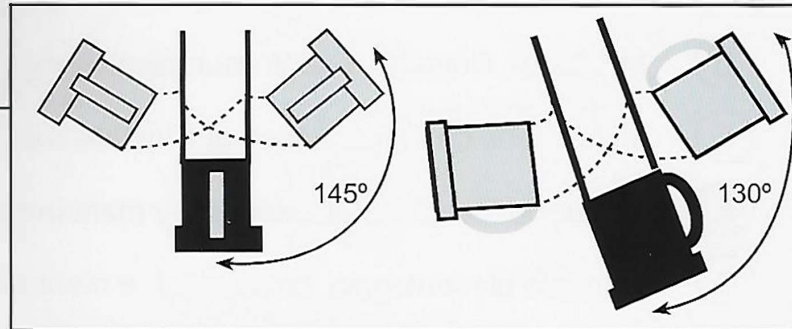
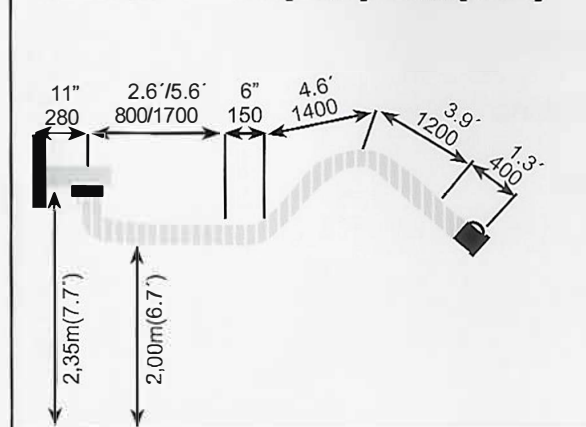

3x90°	Pressure drop					
	600m ³ /h•300CFM $\varnothing 160\text{mm}$ (6.5")	800m ³ /h•400CFM $\varnothing 160\text{mm}$ (6.5")	1000m ³ /h•600CFM $\varnothing 160\text{mm}$ (6.5")	1200m ³ /h•685CFM $\varnothing 200\text{mm}$ (8")	1500m ³ /h•850CFM $\varnothing 200\text{mm}$ (8")	1750m ³ /h•1000CFM $\varnothing 200\text{mm}$ (8")
Flexi 1.5-2m	270 Pa (1.1")	450 Pa (1.8")	810 Pa (3.2")	175 Pa (0.7")	275 Pa (1.1")	400 Pa (1.6")
Flexi 3m (10')	290 Pa (1.2")	510 Pa (2.0")	900 Pa (3.6")	200 Pa (0.8")	300 Pa (1.2")	450 Pa (1.8")
Flexi 4m (14')	310 Pa (1.3")	580 Pa (2.3")	990 Pa (4.0")	250 Pa (1.0")	350 Pa (1.4")	500 Pa (2.0")
Flexi 5m (17')	330 Pa (1.4")	650 Pa (2.6")	1080 Pa (4.3")	275 Pa (1.1")	400 Pa (1.6")	600 Pa (2.4")

Assembly

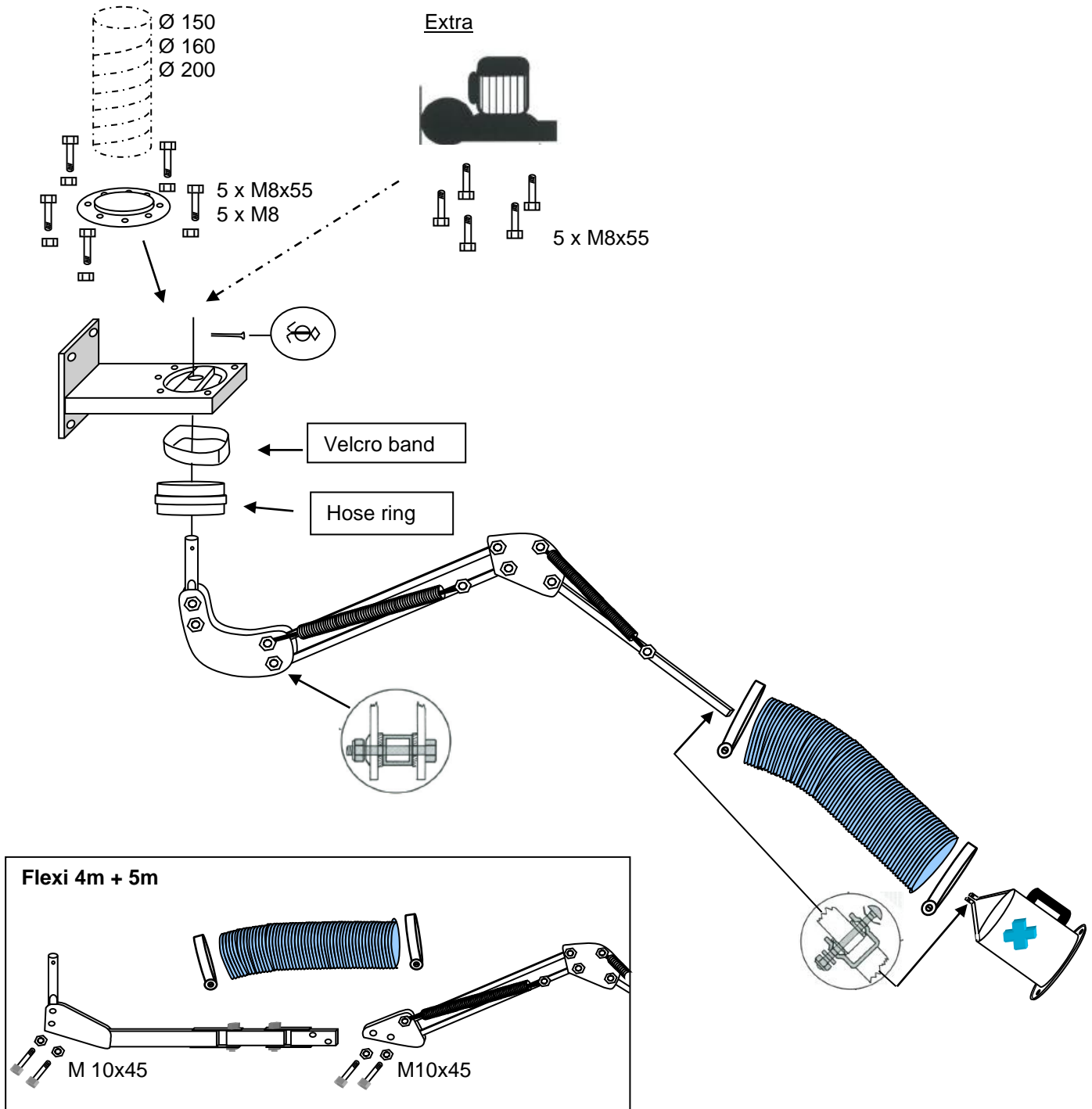

Assembly

1. Mount the wall bracket
2. Mount the parallelogram arm
3. Pull the hose over the parallelogram arm
4. Mount the hood
5. Fasten the hose

5. Spare parts.

Spare parts **Flexi** Ø 160/200mm

Only use original Spare parts to maintain the status of the installation

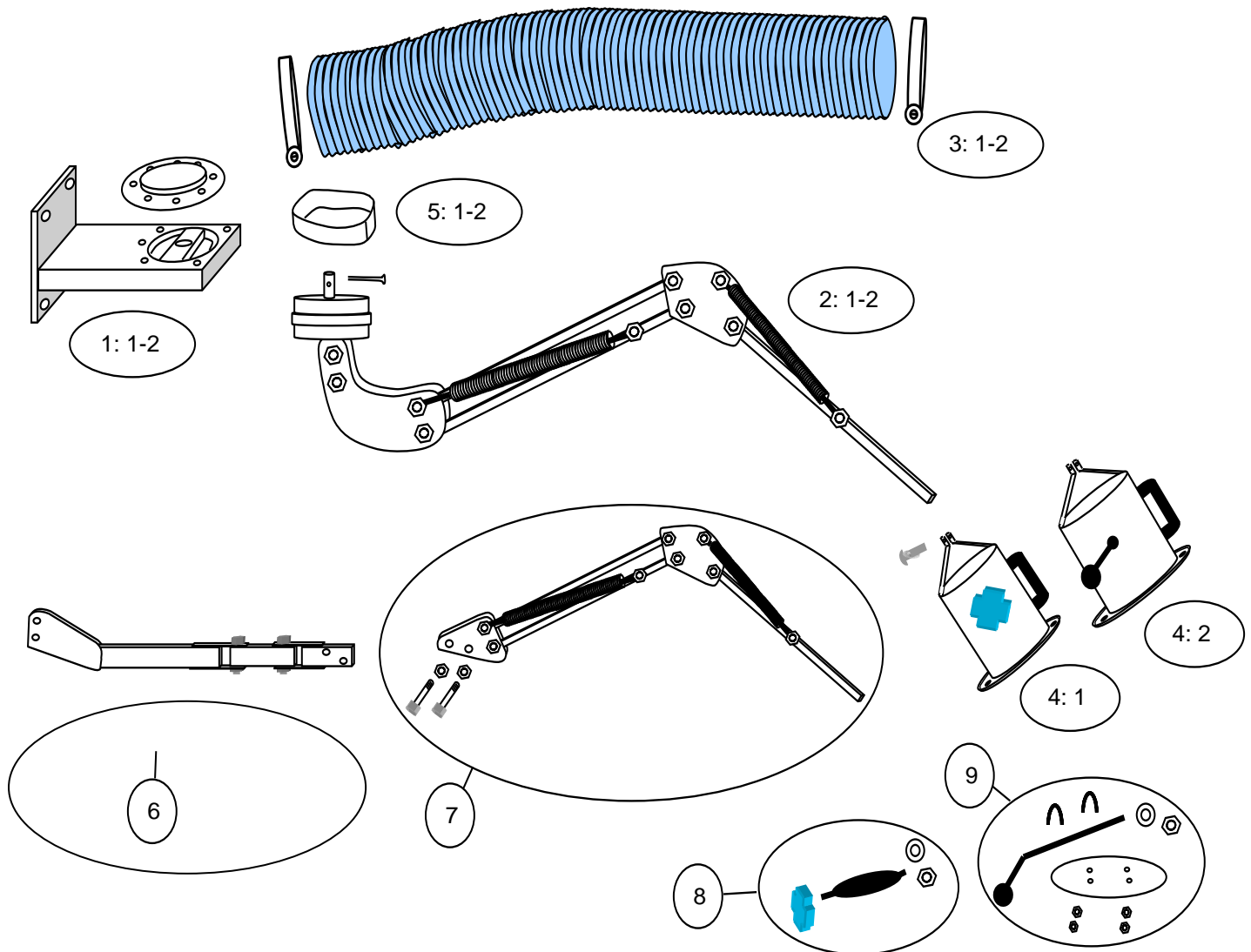

No	Specification	Flexi				
		1,5m	2m	3m	4m	5m
1:1	Wallbracket Ø 160mm	R-146	R-146	R-146	R-146	R-146
1:2	Wallbracket Ø 200mm	R-147	R-147	R-147	R-147	R-147
2:1	Parallelogram Ø 160mm	R-148	R-150	R-152	-	-
2:2	Parallelogram Ø 200	R-149	R-151	R-153	-	-
3:1	Hose set Ø 160mm	R-075	R-075	R-076	R-078	R-079
3:2	Hose set Ø 200mm	R-082	R-082	R-083	R-084	R-085
4:1	Hood ø 160 mm	R-155	R-155	R-155	R-155	R-155
4:2	Hood ø 200 mm	R-156	R-156	R-156	R-156	R-156
5:1	Velcro band Ø 160mm	R-157	R-157	R-157	R-157	R-157
5:2	Velcro band Ø 200mm	R-158	R-158	R-158	R-158	R-158
6	Horisontal interior arm	-	-	-	R-163	R-164
7	Parallelogram Ø 160/200mm	-	-	-	R-154	R-154
8	Damper set Ø 160mm	R-159	R-159	R-159	R-159	R-159
9	Damper set Ø 200mm	R-160	R-160	R-160	R-160	R-160

6. Maintenance

We recommend regular safety controls at least once a year on the following points: Control the bolts of the wallbracket.

Control the hose, no damages etc.

Control bakelite washers and Bolts. See below.

Control the airvolume.

Flexi[®] 2m(7')•3m(10')

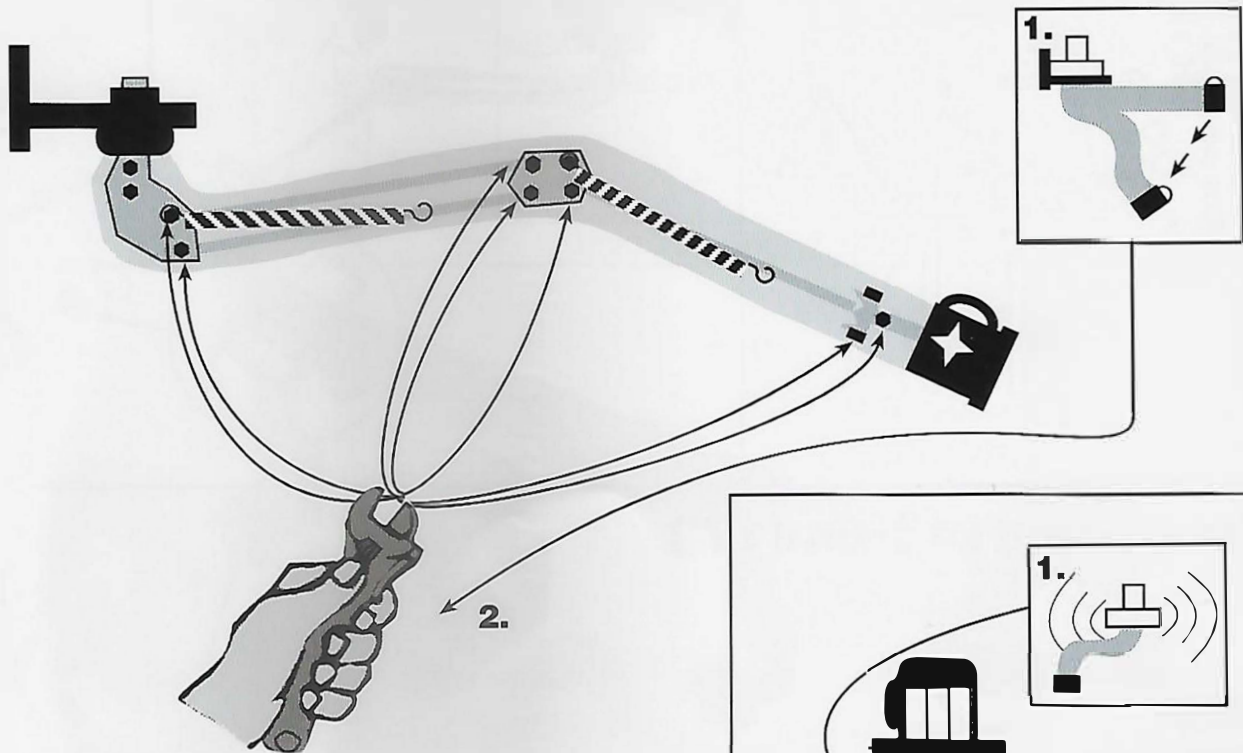

Flexi[®] 4m(14')•5m(17')

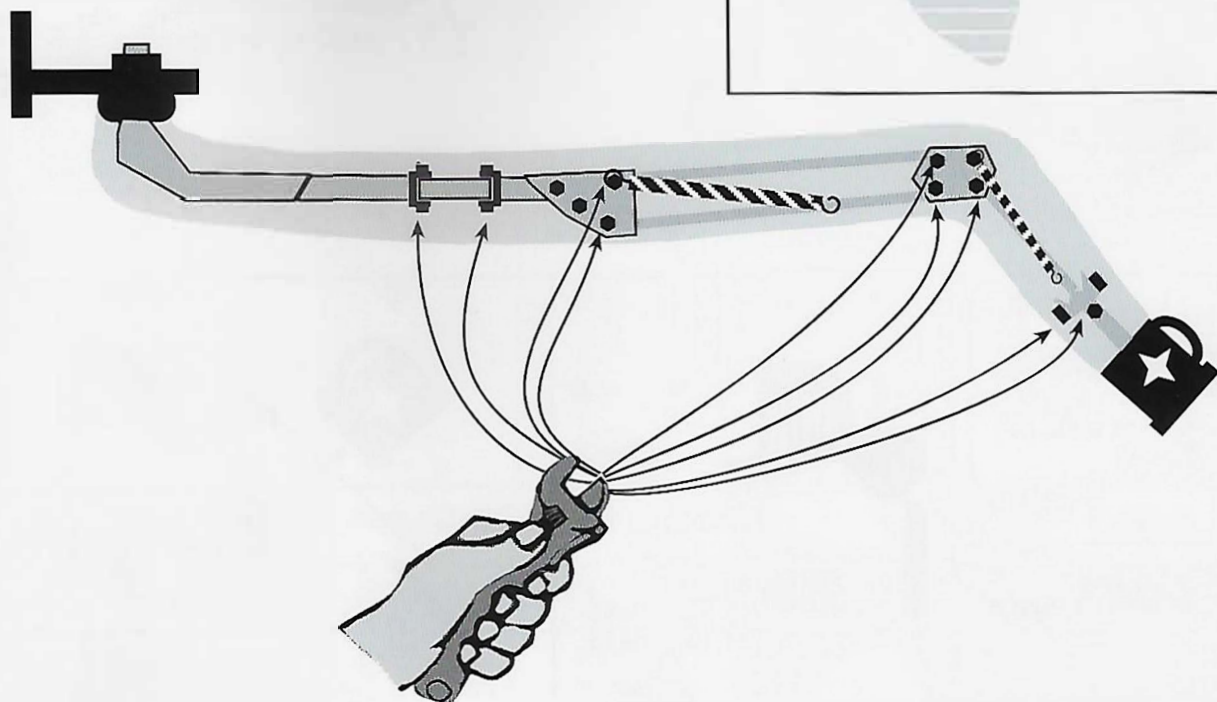

7. Declaration of conformity

We, J. Plymoth AB, declare under our sole responsibility that the product lines **Flexa, Chemikus, Flexi, Super-Max and Super-Vac** to which this declaration relates is in conformity with Directives 2006/42/EC and Standards EN ISO 12100:2010 and EN ISO20607;2019.

J. Plymoth AB
Traryds Allen 4D
28772 Traryd



Jenny Nilsson
Verkställande Direktör

2023-01-01